

Set of 2 long arms



003.1002 Set of 2 long arms WHITE ** increases bracket with 64,5 mm Ø

For projectors with a larger mounting distance than 321 mm, one or two sets of 2 long arms can be added. The maximum reach can be increased to 385,5 mm with 2 arms, and to 451 mm with 4 longer arms.

Set of 2 long arms

Features

Maximum length: 200 mm (standard 140 mm)

Weight: 0.25 kg

Colour: White

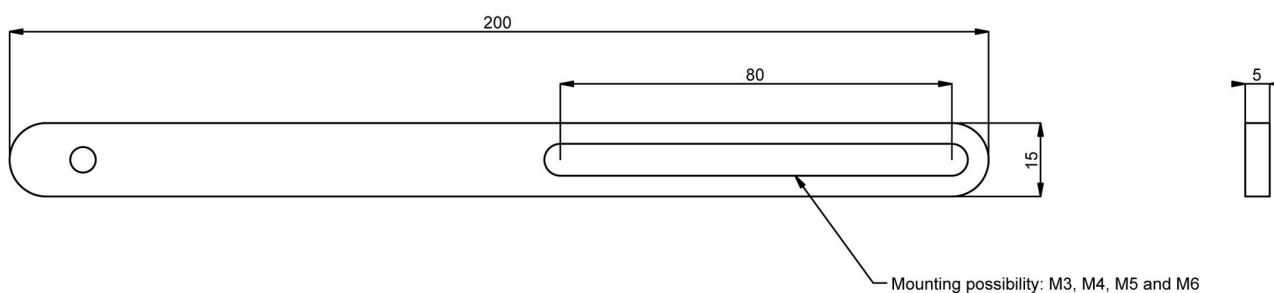

Set of 2 long arms:
These can be used if the standard
arms are not long enough.
Usable with Universal Brackets