

Set of 2 long arms



002.1002.01 DISCONTINUED | Set of 2 long arms BLACK * increases Ø with 64.5 mm

This product is no longer available, we would like to offer you an alternative.

SmartMetals Mounting Solutions is 100% owned by the Vogel's Group.

We are currently merging products / product groups to be able to offer you a good and comprehensive product range.

[For a fitting alternative to this product please contact our Sales department.](#)

Set of 2 long arms

Features

Maximum length: 200 mm (standard 140 mm)

Weight: 0.25 kg

Colour: Black

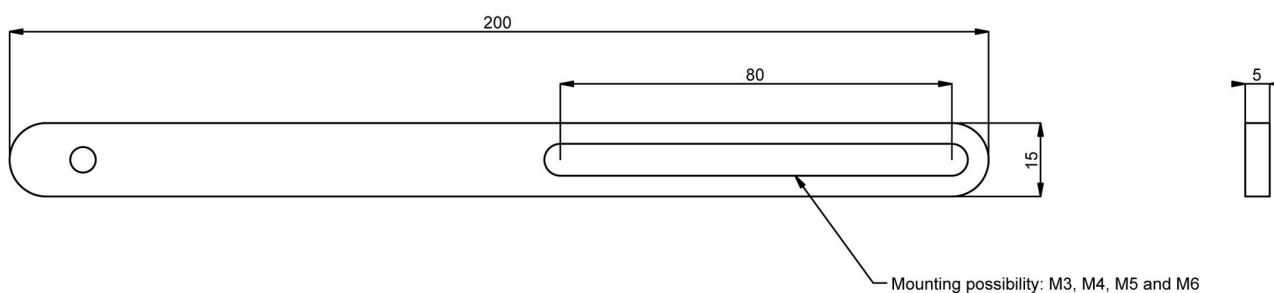

Set of 2 long arms:
These can be used if the standard
arms are not long enough.
Usable with Universal Brackets